

HIGHER GROUND ACADEMY NEW SECONDARY SCHOOL

Information on the Higher Ground Academy New Secondary School Proposal for 317 Marshall Avenue, Saint Paul, Minnesota

Higher Ground Academy is a K-12 charter school located at 1381 Marshall Avenue in Saint Paul. The current location serves approximately 800 students, mainly of East African descent. The Higher Ground Academy is exploring relocating the middle and high school programs to a new location at 317 Marshall Avenue, at the CLC building site currently occupied by Saint Paul College.

Project Scope

Approximately 10,000 square feet of an existing one-story building on the site will be remodeled, and 35,000 square feet of new construction will be added to the site to accommodate 450 students in the 7-12 charter school program. The design for the new building will use materials and colors that complement the neighborhood and Saint Paul College. Construction is to start in the fall of 2018 and be completed for occupancy in the fall of 2019.

Higher Ground Academy and Saint Paul College hope to create a collaborative partnership in developing a new building and curriculum at this site that will flexibly work for both institutions.

Zoning Variances

The school will be applying to the City of St. Paul for a few zoning variances for the project, these variances will not impact other properties in the neighborhood. The required zoning variances are:

- The proposed building footprint will cover more than the 30% of the site.
- The rear yard setback next to the parking area will be less than the required 25 feet.
- Parking will be accommodated through a shared parking agreement with Saint Paul College.



Proposed Exterior Concept for New Higher Ground Academy New Secondary School

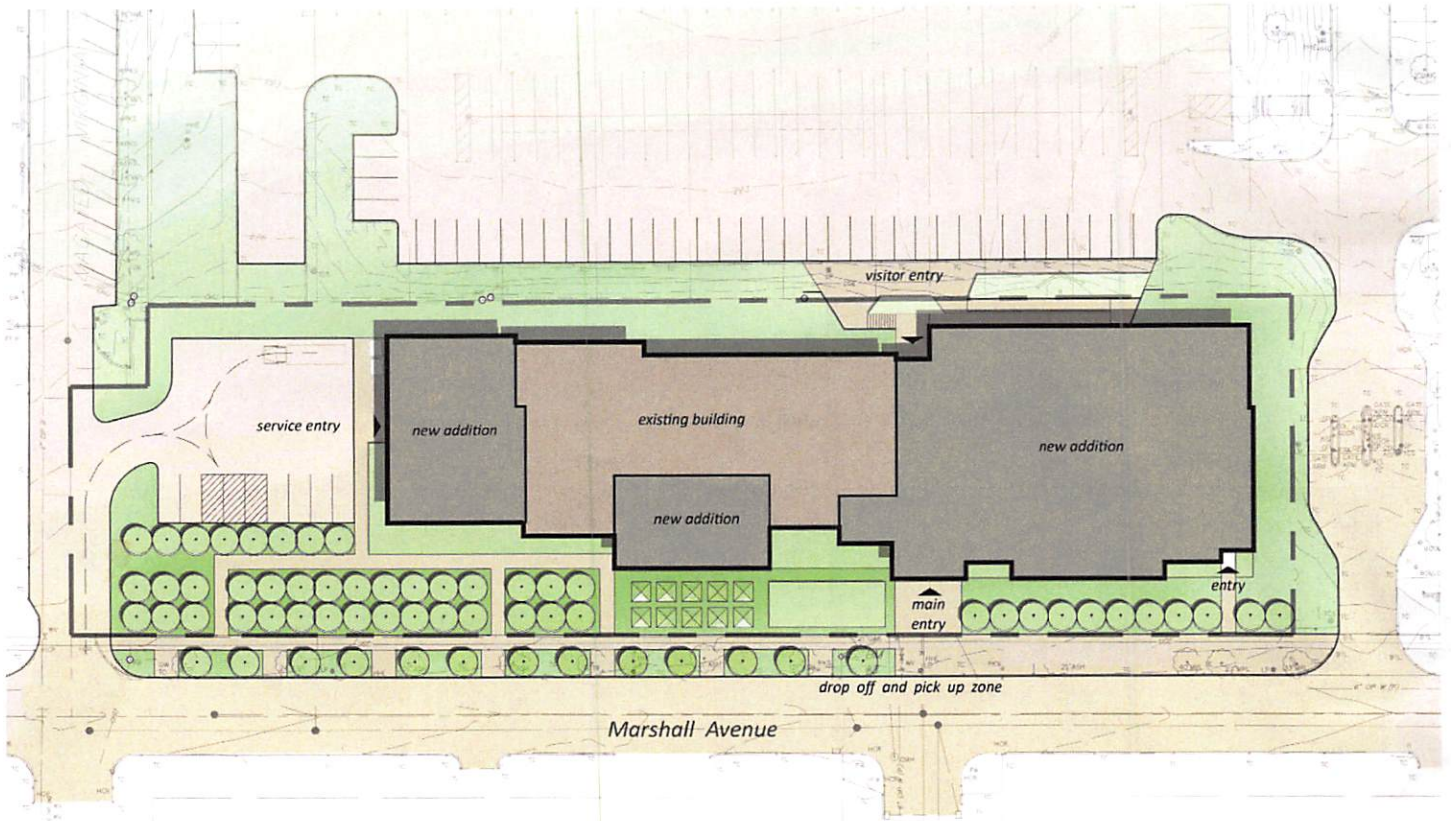

Proposed Site Plan for the New Higher Ground Academy Secondary School

Hours of Operation and Transportation

The hours of operation for the school will be from 7:30 am to 2:30 pm, with some extended afternoon programs that will run until 4 pm. Bus and car drop off and pick up, in front of the building on the north side of Marshall Avenue, will be from 7:00-9:00 am and 2:30-4:30 pm. Most of the students will arrive by bus.

Students are not allowed to drive to school, and the approximate 40 school staff will park in the Saint Paul College parking lot to the north of the building. Currently, the school is planning on using up to 8 buses, but will also consider staging only 2 or 3 buses at a time in front of the school.

NEIGHBORHOOD MEETING - PLEASE JOIN US!

Saint Paul College will be hosting a neighborhood meeting for this project on

Monday, March 19th, at 7:00 pm

Saint Paul College, Room 1510 on the first floor of the new Health Science Addition

For questions or concerns please contact:

Project Team Members:

Bill Wilson, Executive Director, Higher Ground Academy
billwilson168@hotmail.com

Brian Sweeney, Development Consultant
sweeneydev@gmail.com

Darryl Pratte, Project Architect
dpratte@cunningham.com

The Neighborhood Council will also be reviewing and commenting on the project, please reach out if you have questions or concerns:

Jens Werner, Executive Director
 Summit-University Planning Council
jens@summit-university.org

